

hp-Pressure-regulating valve of Series B-PRO

B-PRO model

B-Pro valves are used to control system pressure and flow. They are available in 4 sizes with capacity up to 2000 l/h. The valves are used in connection with spillback nozzles, where pressure and flow in the spillback determine the nozzle capacity.

Maximum temperature of fluid medium: 150°C

Material: casing (GGG 40); certificate 3.1 on request; piston, stop pin, spring of hardened steel

Usage and characteristics:

- Light and heavy oil
- Oil burner with spillback nozzles



| B-PRO                               | Size                      | B-PP-PRO                    | B-P-PRO | B-G-PRO                     | B-GH-PRO |         |         |         |         |         |
|-------------------------------------|---------------------------|-----------------------------|---------|-----------------------------|----------|---------|---------|---------|---------|---------|
| Viscosity range (measured in inlet) | cSt. (mm <sup>2</sup> /s) | 1.3 - 700                   |         |                             |          |         |         |         |         |         |
| Pressure range                      | bar                       | Pressure stage 2 (2-22 bar) |         | Pressure stage 4 (5-45 bar) |          |         |         |         |         |         |
| Factory setting                     | bar                       | Minimum pressure            |         |                             |          |         |         |         |         |         |
| Weight                              | kg                        | 0.6                         | 1.2     | 1.2                         | 2.6      |         |         |         |         |         |
| max. oil temperature                | °C                        | 150                         |         |                             |          |         |         |         |         |         |
| Ambient temperature                 | °C                        | -10 to +90                  |         |                             |          |         |         |         |         |         |
| Storage temperature                 | °C                        | -20 to +60                  |         |                             |          |         |         |         |         |         |
| Item No.                            | Pressure stage 2          | Pressure stage 4            | 0250310 | 0250312                     | 0250314  | 0250316 | 0250318 | 0250320 | 0250322 | 0250324 |

Flow rate

|              | Minimum in l/h | Nominal in l/h | Maximum in l/h |
|--------------|----------------|----------------|----------------|
| B - PP - Pro | 20             | 60             | 120            |
| B - P - Pro  | 45             | 160            | 300            |
| B - G - Pro  | 90             | 300            | 600            |
| B - GH - Pro | 300            | 1000           | 2000           |

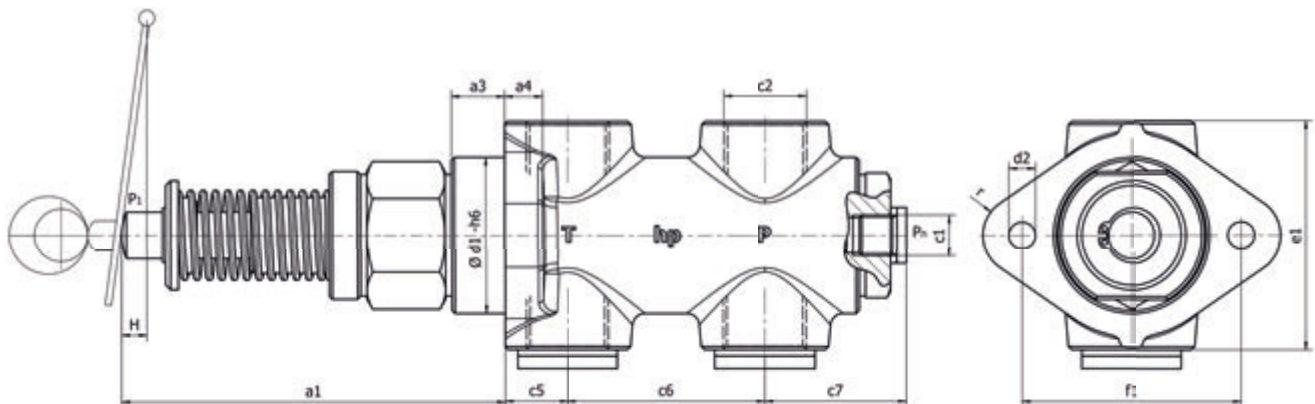

- T Return connection to tank
- P Pressure outlet
- P<sub>n</sub> Pressure gauge port
- P<sub>1</sub> Pressure and flow setting

| Model    | a1  | a3 | a4 | c1    | c2    | c5 | c6 | c7 | d1 | d2  | e1 | f1 | H  | r    |
|----------|-----|----|----|-------|-------|----|----|----|----|-----|----|----|----|------|
| B-PP-PRO | 73  | 10 | 8  | G1/8" | G1/4" | 12 | 43 | 34 | 26 | 5.5 | 40 | 40 | 6  | 8    |
| B-P-PRO  | 90  | 12 | 10 | G1/8" | G3/8" | 15 | 65 | 37 | 32 | 6.2 | 55 | 51 | 10 | 8    |
| B-G-PRO  | 90  | 12 | 10 | G1/8" | G3/8" | 15 | 65 | 37 | 32 | 6.2 | 55 | 51 | 10 | 8    |
| B-GH-PRO | 121 | 17 | 12 | G1/8" | G3/4" | 20 | 63 | 48 | 50 | 8.4 | 70 | 70 | 12 | 12.5 |